

FM/AM Portable CD Player

Operating Instructions 使用說明書



D-FJ200

©2003 Sony Corporation Printed in China

http://www.sony.net/

“WALKMAN” is a registered trademark of Sony Corporation to represent Headphone Stereo products. **WALKMAN** is a trademark of Sony Corporation.

CD player (front)/CD 唱機 (正面)

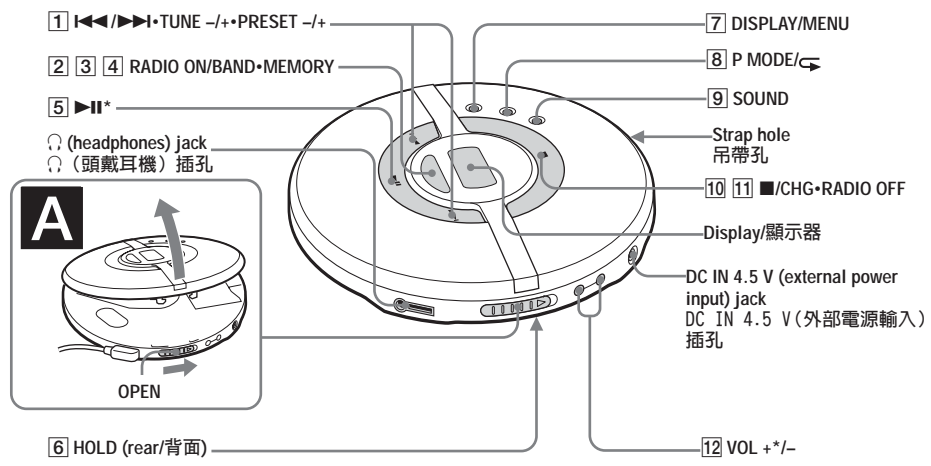

*The button has a tactile dot.
* 按鈕帶有觸感圓點。

CD player (inside)/CD 唱機 (裡面)

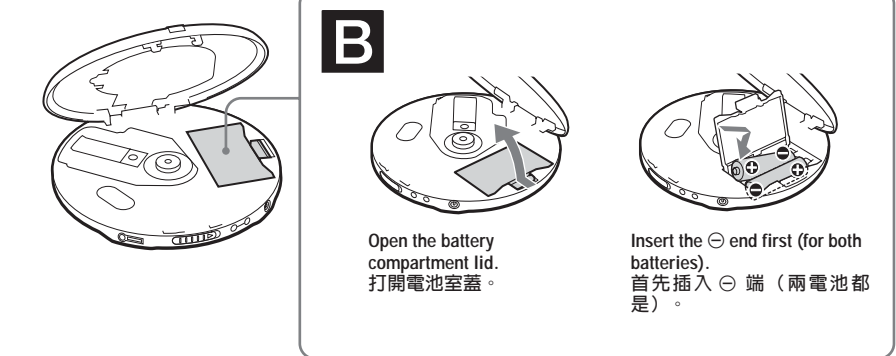

Remote control 遙控器

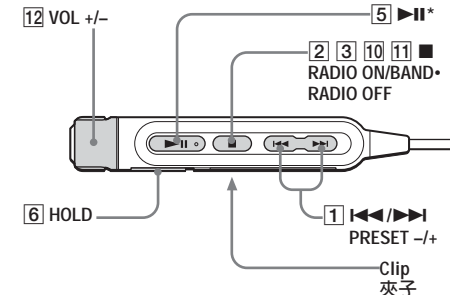

*The button has a tactile dot.
* 按鈕帶有觸感圓點。

Note

Use only the supplied remote control. You cannot operate this CD player with the remote control supplied with other CD players.

Display on CD player CD 唱機上的顯示

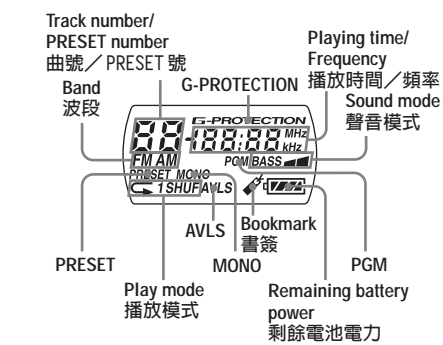

註

限使用附帶的遙控器。不能用其他 CD 唱機所附帶的遙控器去控制操作本 CD 唱機。

C

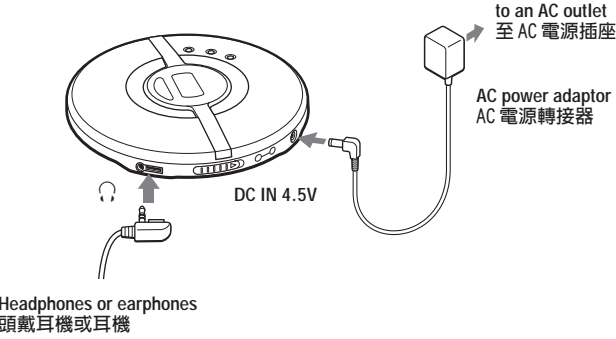

D

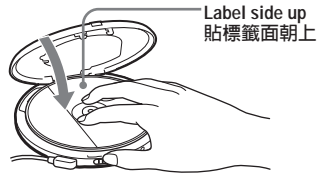

English

WARNING

To prevent fire or shock hazard, do not expose the unit to rain or moisture.

Do not install the appliance in a confined space, such as a bookcase or built-in cabinet.

To prevent fire, do not cover the ventilation of the apparatus with newspapers, tablecloths, curtains, etc. And don't place lighted candles on the apparatus.

To prevent fire or shock hazard, do not place objects filled with liquids, such as vases, on the apparatus.

CAUTION

The use of optical instruments with this product will increase eye hazard.

Certain countries may regulate disposal of the battery used to power this product. Please consult with your local authority.

CAUTION

- INVISIBLE LASER RADIATION WHEN OPEN
- DO NOT STARE INTO BEAM OR VIEW DIRECTLY WITH OPTICAL INSTRUMENT
- CLASS 1M INVISIBLE LASER RADIATION WHEN OPEN
- DO NOT VIEW DIRECTLY WITH OPTICAL INSTRUMENTS

The validity of the CE marking is restricted to only those countries where it is legally enforced, mainly in the countries EEA (European Economic Area).

For the area code of the model you purchased, check the upper left side of the bar code on the package.

Power Sources

To use the AC power adaptor (C)

- 1 Connect the AC power adaptor to an AC outlet.

To use the batteries (B)

Use only the following batteries for your CD player:

Rechargeable batteries

Charge the rechargeable batteries before using them for the first time.

- NH-7WMAA

Dry batteries

- LR6 (size AA) alkaline batteries

To insert the batteries

- 1 Open the battery compartment lid inside your CD player.
- 2 Insert two batteries by matching the ⊕ to the diagram in the battery compartment and close the lid until it clicks into place.
- 3 When using the rechargeable batteries, connect the AC power adaptor to the DC IN 4.5 V jack of your CD player and an AC outlet, then press ■/CHG to start charging. The CD player charges the batteries. The indicator sections of light up in succession and “CHG” appears in the display. When the batteries are completely charged, the “CHG” and indicators get turned off. If you press ■/CHG after the charge has already been completed, the indicator flashes and “Full” appears in the display.
- 4 Disconnect the AC power adaptor.

Battery life* (approx. hours)

(When the CD player is used on a flat and stable place.)
Playing time varies depending on how the CD player is used.

	G-PROTECTION ON	OFF	RADIO ON
Two NH-7WMAA (charged for about 2 hours**)	14	12	21
Two Sony alkaline batteries LR6 (SG) (produced in Japan)	48	42	70

* Measured value by the standard of JEITA (Japan Electronics and Information Technology Industries Association).

** Charging time varies depending on how the rechargeable battery is used.

E



To check the remaining power of the batteries

You can check it in the display. Replace the batteries when “” flashes.

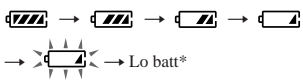

*Beep sounds.

Notes

- The indicator sections of roughly shows the remaining battery power. One section does not always indicate one-fourth of the battery power.
- Depending on operating conditions, the indicator sections of may increase or decrease.

When to replace the rechargeable batteries

If the battery life becomes shorter by about half, replace the batteries with new rechargeable batteries.

Notes on the rechargeable batteries

- To keep the original battery capacity for a long time, charge the batteries only when they are completely depleted.
- If the battery is new or has not been used for a long time, it may not be charged completely until you charge and discharge it several times.
- When carrying the rechargeable batteries, use the supplied battery carrying case to prevent unexpected heat. If the rechargeable batteries and the metallic objects get contacted, heat or fire may occur due to a short circuit.

Notes on using the dry batteries

- Be sure to remove the AC power adaptor.
- When the batteries are depleted, replace both batteries with new ones.

Playing a CD

To insert a CD

- 1 Slide OPEN to open the lid (A).
- 2 Fit the CD to the pivot, then close the lid (D).

Notes

- This CD player can play CD-Rs/CD-RWs recorded in the Compact Disc Digital Audio (Audio CD) format, but playback capability may vary depending on the quality of the disc and the condition of the recording device.
- This product is designed to play back discs that conform to the Compact Disc (CD) standard. Recently, various music discs encoded with copyright protection technologies are marketed by some record companies. Please be aware that among those discs, there are some that do not conform to the CD standard and may not be playable by this product.

To operate the CD player

Button/Switch	Function/Operation
1 ◀▶/SEARCH (AMS*)/TUNE -/+ PRESET -/+	For CD player: Press ◀▶ or ▶▶ once to find the beginning of the current/next track. Press ◀▶ or ▶▶ repeatedly to find the beginning of the previous/succeeding tracks. Press and hold ◀▶ or ▶▶ to go backward/forward quickly. For radio: Press to tune in the station you want. Also press to select the preset station you want.
2 RADIO ON	Press to turn on the radio.
3 BAND	Press to change the band.
4 MEMORY	Press and hold to enter the preset mode. Also press to store the station in memory.
5 ▶ (play/pause)	• Press to start play. Press again to pause play. To play from the first track, press for 2 seconds or more while the CD player is stopped. • Also press to enter the selection.
6 HOLD	Use to lock the controls to prevent accidental button presses.
7 DISPLAY/MENU	• Press once to display “track number and remaining time of the current track.” Press twice to display “the number of tracks left and the time remaining on the CD.” Press three times to display “track number and elapsed playing time (normal display).” • Also press to enter the menu and to enter the selection.

Button/Switch	Function/Operation
8 P MODE/ (play mode/repeat)	For CD player: During play, press repeatedly until the play mode you want appears in the display. No indication: Normal play “1”: Single track play “SHUF”: Shuffle play “📌”: Bookmark track play “PGM”: PGM (program) play To repeat the play mode you selected, press and hold until “◀▶” appears. For radio: Press to switch the tuning mode and the preset mode.
9 SOUND*	• Use to emphasize the bass-boosted sound. Press repeatedly to select BASS or BASS . BASS enhances more than BASS .* • Also use to keep down the maximum volume to protect your hearing. Press and hold until “AVLS**” appears in the display. The AVLS function is turned on. To turn off the AVLS function, press and hold again until “AVLS” disappears.
10 ■ (stop)/CHG (charge)	Press to stop playing. (HK4 model only) Also press ■/CHG on the CD player to start charging.
11 RADIO OFF	Press to turn off the radio.
12 VOL +/-	Press to adjust the volume.

*AMS = Automatic Music Selector

**If you disconnect the power sources, all settings return to the defaults.

**If the sound is distorted when using the SOUND function, turn down the volume.

*AVLS = Automatic Volume Limiter System

To remove the CD

Remove the CD while pressing the pivot (E).

中文

警告

為防火災或觸電危險，切勿讓機器暴露於雨中或潮濕處。

別把機器安裝在諸如書櫥或壁櫥等密閉處。

為防火災，請勿讓裝置的通風孔蓋住報紙、桌布、窗簾等。也不可在裝置上點放蠟燭。

為防火災或觸電危險，不可在裝置上擺飾花瓶等裝滿液體的物體。

一部分國家對於本產品的電源用電池可能規定有處置的標準。請洽詢當地有關當局。

注意

- 開著時，將有看不見的雷射線
- 別凝視雷射線或直接觀看裡面的光學元件
- 開著時，將有看不見的 CLASS 1M 雷射線
- 別直接觀看裡面的光學元件

CE 標誌的有效性，僅限於那些有法律限制的國家，主要在 EEA (歐洲經濟區) 國家。

您購入型號的區域碼，請查看包裝上的條碼碼的左上角。

連接電源

使用 AC 電源轉接器 (C)

- 1 將 AC 電源轉接器連接到 AC 電源插座。

使用電池 (B)

本 CD 唱機限使用下列電池：

充電式電池

- NH-7WMAA

乾電池

- LR6 (AA，3 號) 鹼性電池

插入電池

- 1 打開 CD 唱機裡面的電池室蓋。
- 2 裝入 2 個電池使 ⊕ 對準電池室中的圖示，然後關上蓋子至卡搭定位。
- 3 當使用充電式電池時，將 AC 電源轉接器連接到您的 CD 唱機上的 DC IN 4.5V 插孔和 AC 電源插座，然後按 ■/CHG 以開始充電。CD 唱機給電池充電。 指示燈各段陸續點亮，“CHG”出現在顯示器上。當充電完成時，“CHG”和 指示燈熄滅。充電完成後如果按 ■/CHG， 指示燈閃爍，“Full”出現在顯示器上。
- 4 斷開 AC 電源轉接器。

電池使用時間* (大約時數)

(在平穩表面使用 CD 唱機時)
播放時間因 CD 唱機的使用狀況而異。

	G-PROTECTION 設定		RADIO ON
	ON	OFF	
兩 NH-7WMAA (充電大約 2 小時**)	14	12	21
兩 Sony 鹼性電池 LR6 (SG) (日本製)	48	42	70

* JEITA (Japan Electronics and Information Technology Industries Association) (日本電子和資訊技術產業協會) 的標準測值。

** 充電時間，隨充電式電池的使用狀況而異。

檢查電池剩餘電力

可以在顯示器上檢查。
當 “” 閃爍時請更換電池。

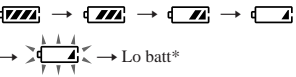

* 嗶聲。

註

- 的指示段節粗示剩餘電池電力。其一個段節不一定正確代表電池電力的四分之一。
- 根據操作條件， 的指示段節的使用時間可能增加或減少。

何時更換充電式電池

當電池使用時間縮短到大約一半時，即請更換新的充電式電池。

充電式電池須知

- 為保持充電式電池原有容量維持長時間的電池使用時間，請在完全耗盡電力時才給電池充電。
- 新充電式電池或擺置長時間沒用的充電式電池，可能不能完全充滿電，須等充電使用過數次之後才能達到完全充滿電。
- 請利用附帶的電池攜帶盒以防意外生熱。讓充電式電池和金屬小件物品混合放置，可能因發生短路而生熱，甚至有起火危險。

使用乾電池的注意事項

- 務必卸下 AC 電源轉接器。
- 當電池用光時，同時更換兩節新電池。

播放 CD

插入 CD

- 1 滑動 OPEN 打開頂蓋 (A)。
- 2 把 CD 按入中心軸，然後蓋上頂蓋 (D)。

註

- 本 CD 唱機可以播放以雷射光碟數位音訊 (音訊 CD) 格式錄製的 CD-R/CD-RW。但播放能力取決於光碟質量和錄音設備的狀況。
- 本產品設計用於播放符合 Compact Disc (CD) 標準的光碟。近來，許多錄製公司都出售各種用版權保護技術編碼的音樂光碟。請注意，這些光碟中可能有不符合 CD 標準的光碟，且可能無法用本產品播放。

操作 CD 唱機

按鈕 / 開關	功能 / 操作
1 ◀▶/SEARCH (AMS*)/TUNE -/+ PRESET -/+	對於 CD 唱機：按 ◀▶ 或 ▶▶ 一次查找當前 / 下一曲子的開頭。反復按 ◀▶ 或 ▶▶ 查找前面 / 後面的曲子的開頭。按住 ◀▶ 或 ▶▶ 快退 / 快進。對於收音機：按此按鈕調入所要的電台。也可按此按鈕選擇所要的預設電台。
2 RADIO ON	按此按鈕打開收音機。
3 BAND	按此按鈕改變波段。
4 MEMORY	按住此按鈕進入預設模式。按此按鈕也可在存儲器中保存電台。
5 ▶ (播放 / 暫停)	• 按此按鈕開始播放。再按一次暫停播放。 • 要從第一個曲子開始播放，當 CD 唱機停止時，按住此鈕 2 秒以上。 • 按下時也用於輸入選擇。
6 HOLD	用於鎖定控制鈕以防意外按動。
7 DISPLAY/MENU	• 按一次顯示“曲號和當前曲子剩餘時間”。 • 按兩次顯示“剩餘曲子數和 CD 上的剩餘時間”。 • 按三次顯示“曲號和已播放時間 (正常播放)”。 • 按下時也用於輸入功能表 and 選擇。
8 P MODE/ (播放模式 / 重現)	對於 CD 唱機：播放期間，反復按直到所要的播放模式出現在顯示器上。 無顯示：正常播放 “1”：單首曲子播放 “SHUF”：隨機播放 “📌”：書籤軌跡播放 “PGM”：PGM (程式) 播放 要重現選定的播放模式，按住此鈕直到 “◀▶” 出現。 對於收音機：按此按鈕切換調諧模式和預設模式。
9 SOUND*	• 用來加強低音。反復按此鈕以選擇 BASS 或 BASS 。BASS 的作用強於 BASS 。* • 也用來限制最大音量以保護聽力。按住此鈕直到 “AVLS**” 出現在顯示器上。AVLS 功能開啓。要關閉 AVLS 功能，再次按住此鈕直到 “AVLS” 消失。

